

RD/2C-10

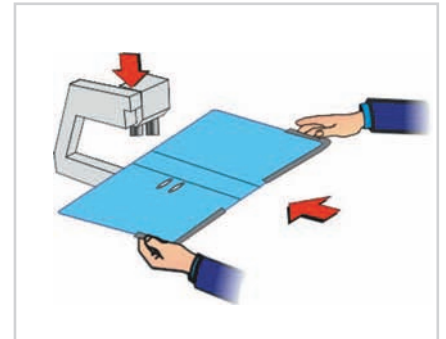

Motor driven manual machine to apply nr. 02 Rado eyelets – Board feeding by hand – Punching and applying operation without board shifting - Eyelet feeding via vibrator

Machine manuelle à moteur pour poser nr. 02 Œillets Rado – Positionnement à la main du plat - Perforation et application œillets sans déplacer le carton – Alimentation des œillets par vibreur



- Used materials: Rado eyelets Ref. "934"
- Board thickness : 1 up to 2,5mm
- Capacity: approx. 12 cycles/minute
- Tension: 220 V – single phase
- Weight: 280 Kg.
- Overall dimensions: L= 1080mm; W= 620mm; H= 1550mm

- Matériel employé: œillets rado Art. "934"
- Epaisseur carton: de 1 à 2,5mm
- Production: approx. 12 pièces/minute
- Tension: 220 V – mono-phase
- Poids: 280 Kg.
- Encombres: L= 1080mm; P= 620mm; H= 1550mm

* Production capacity of every machine depends on sizes, type of materials, glues and operator skill
 Peroni's policy is one of continual product improvement and we can reserve the right to alter design and/or specifications without notice